



CHARLES KNIGHT
ESTATE AGENTS



244 Baring Road , London, SE12 0UL Guide price £400,000

£400,000 - £425,000 Guide Price

Offered to the market with no onward chain, this spacious three-bedroom terraced house presents an excellent opportunity for families and buyers looking to put their own stamp on a well-located home.

Ideally situated close to a range of local shops, amenities, reputable schools and excellent transport links, including Grove Park Station, the property offers both convenience and strong commuter connections.

Internally, the home provides generous living accommodation throughout, featuring a bright and airy reception room, a separate fitted kitchen, three well-proportioned bedrooms and a family bathroom. While the property would benefit from some internal redecoration, it offers fantastic potential to create a stylish and comfortable family home tailored to individual tastes.

Further benefits include a private rear garden, ideal for outdoor entertaining or family use, as well as a garage providing additional storage or off-street parking.

Early viewing is highly recommended to fully appreciate the space, potential and location this property has to offer

Viewing

Please contact our Lewisham Office on 02088 524441 if you wish to arrange a viewing appointment for this property or require further information.

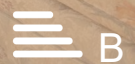

Floor Plan

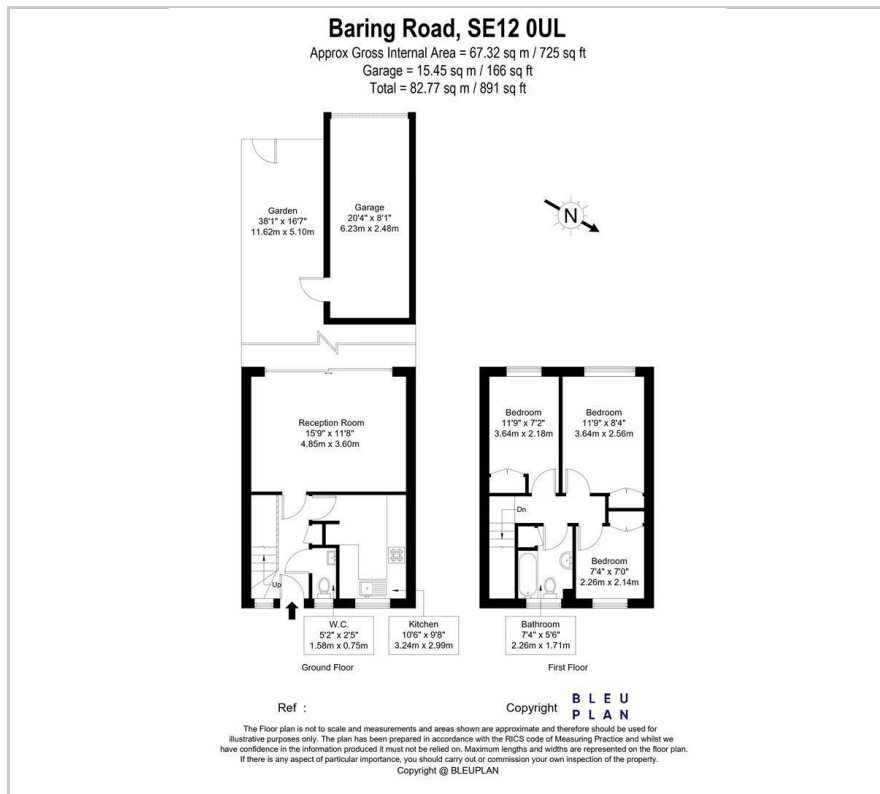

Area Map

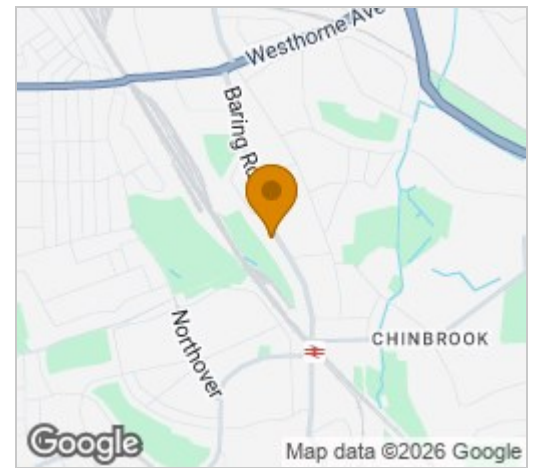

Energy Efficiency Graph

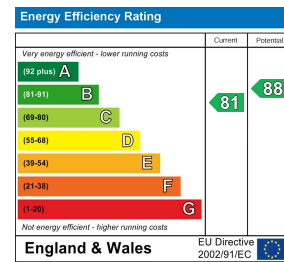

These particulars, whilst believed to be accurate are set out as a general outline only for guidance and do not constitute any part of an offer or contract. Intending purchasers should not rely on them as statements of representation of fact, but must satisfy themselves by inspection or otherwise as to their accuracy. No person in this firm's employment has the authority to make or give any representation or warranty in respect of the property.